

CARBON COUNTY MUSEUM
3 BLOCKS WEST AT
904 WEST WALNUT

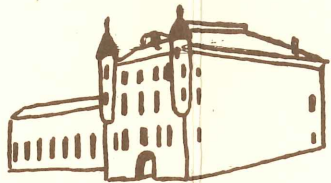

WYOMING FRONTIER PRISON

Rawlins Historic Downtown Walking Tour

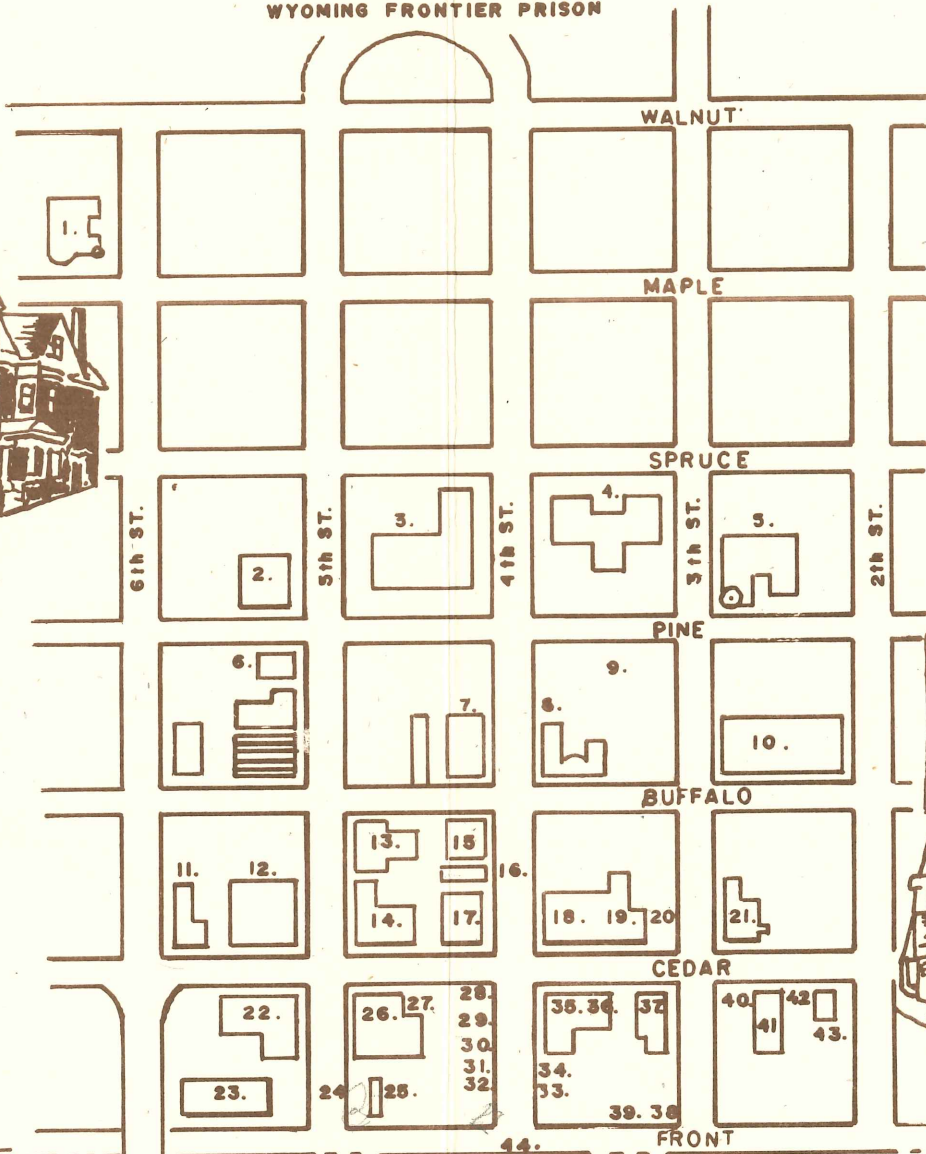

1. Ferris Mansion
2. Shrine Temple
3. Carbon County Courthouse
4. Jeffrey Center
5. St. Joseph's Catholic Church
6. F.F. "Kraft Hall"
7. The Elks Lodge
8. Ferris Hotel
9. Private Residence
10. Carbon Building
11. City Hall
12. The Miller Daley Building
13. The Rawlins Police Department
14. Hugus/Ferguson Building
15. First National Bank Building
16. The Leo Keller Building
17. 401 East Cedar
18. Mercantile Co. Building
19. Odd Fellows Building
20. Lincoln Highway Garage
21. The Blake House
22. Osborne Building
23. U.S. Post Office
24. NE Corner of Front & 5th Street
25. Wyoming Bar
26. 416 West Cedar
27. 410 West Cedar
28. SW Corner of Cedar & 4th Street
29. 120 4th
30. 118 4th
31. 116 4th
32. Brunswick Hotel
33. The Carbon County Journal
34. The Charles Anderson Building
35. Rasmusson Building
36. 304-308 Cedar (Sundin Garage)
37. France Memorial Presbyterian Church
38. NW Corner of North Front & 3rd Street
39. NE Corner of Front & 3rd Street
40. Moose Hall
41. Strand Theatre
42. 214 West Cedar
43. H. Larsen Inc. Building
44. U.P.R.R. Depot
45. South Front Street
46. South Side of Railroad Tracks
47. Wyoming's Frontier Prison

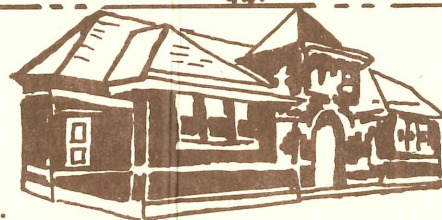
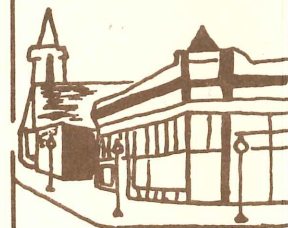
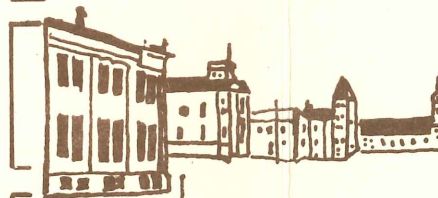

U.P. DEPOT

45. 46.

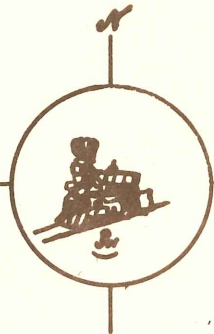

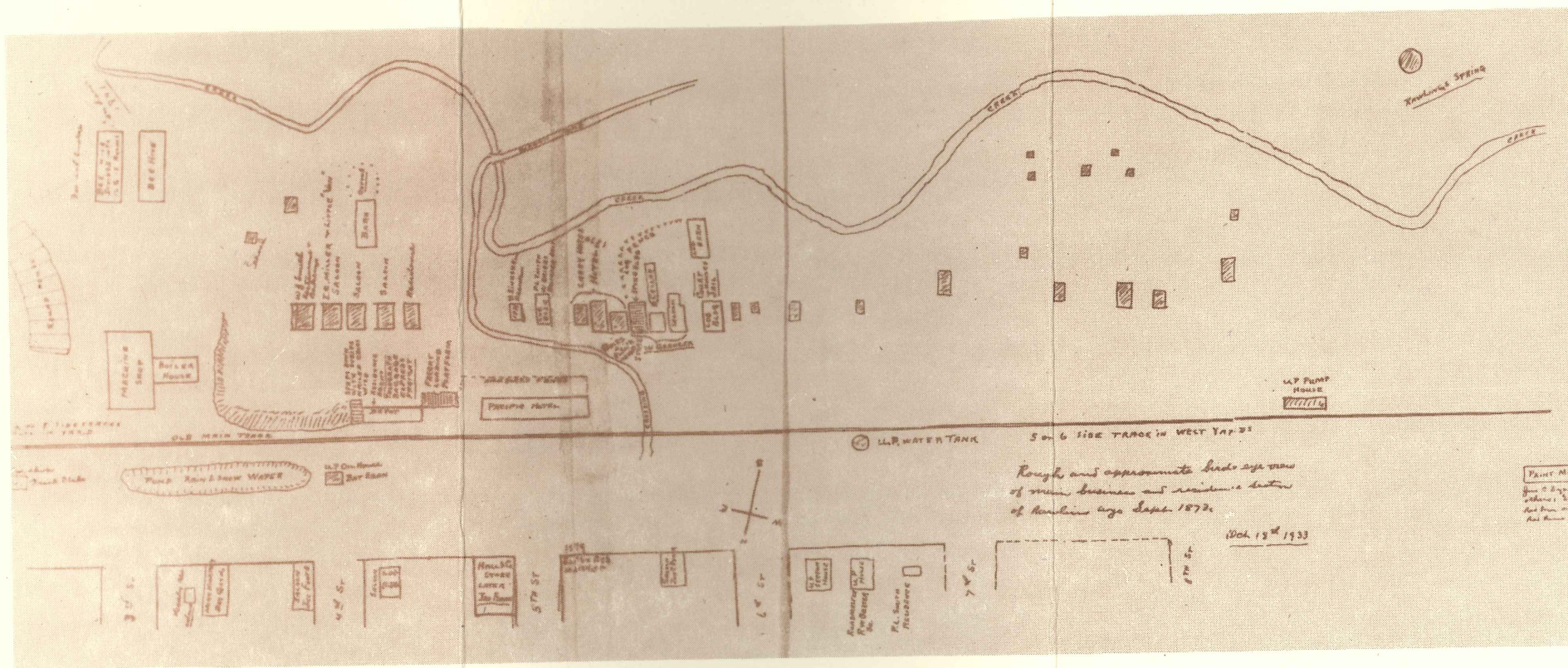

Cover photo is of 4th and Cedar Street, Rawlins in the 1890's. Note Monument Hill in the background

Map of Rawlins in 1873 to 1877 drawn by Rudolph Zingsheim in 1933, whose father, Nicholas Zingsheim, came to Rawlins in 1872 and Rudolph and his mother in 1873. Donated to Carbon County Museum by Rudolph's daughter, the late Mrs. C. A. Brimmer, Sr.